



# GREENHOUSE STUDIOS



## the at **villages** Crest Mountain

• Asheville's Premier Sustainable Eco-Community •

Level 1: 572 SF

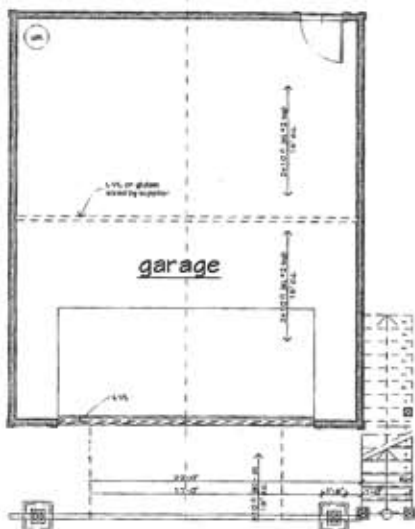

**Total Heated SF: 572**

**1 Bedroom, 1 Bath**

- Rain Water Catchment System
- Low VOC Paint
- Icynene & Formaldehyde Free Insulation
- Low Flow Kitchen & Bath
- Zoned Mini-split Heating & Cooling System
- Hardwood Floors
- Granite Countertops

Level 2: 572 SF



We are excited to introduce the GreenHouse Studios, our entry level, mixed-use offering in the Villages at Crest Mountain. With our two story units, the lower level has a broad range of possible uses, including art studio, home office, storage or garage, just to name a few. Above is a highly efficient residential loft studio unit, perfect for a single or a couple, with lots of light, decks, views of the Central Gardens, and easy access to ALL VCM amenities. Mere steps to the newly renovated Greenhouse. Affordable to purchase and operate, the best value in the region under \$150,000.

**Starting in the \$140's**

6 Celebration Place, Asheville NC 28806

Office 828.252.7787

[Info@VillagesAtCrestMountain.com](mailto:Info@VillagesAtCrestMountain.com)

Visit us online at [www.VillagesAtCrestMountain.com](http://www.VillagesAtCrestMountain.com)